

# Technical Data Sheet

## Product Code:

MC30 Range

## Product Description:

30mm high steel wire cable tray  
50 x 100 mm mesh configuration

## Product Dimensions:

MC3050 - 30 x 50 mm  
MC30100 - 30 x 100 mm  
MC30150 - 30 x 150 mm  
MC30200 - 30 x 200 mm  
MC30300 - 30 x 300 mm  
MC30400 - 30 x 400 mm  
MC30450 - 30 x 450 mm  
MC30500 - 30 x 500 mm

Standard 3 metres length

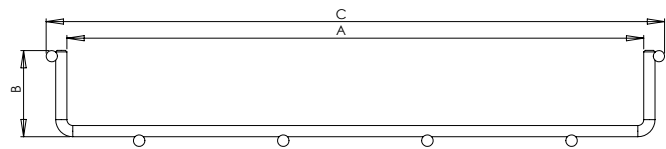
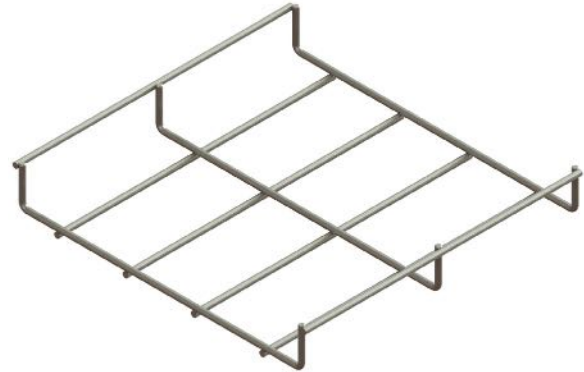

## Applicable Standards:

BS EN 61537 (Cable tray systems)  
BS EN ISO 10244 (Steel wire and wire products)  
BS EN ISO 1461 (Hot dip galvanized coatings)  
BS EN ISO 2081 (Metallic and other inorganic coatings)  
BS EN 13438 (Powder organic coatings)

## Product Specification:

Manufactured: Machine welded from steel wire rod

PART CODE	'A' DIMENSION	'B' DIMENSION	'C' DIMENSION
MC3050	50	30	64
MC30100	100	30	114
MC30150	150	30	164
MC30200	200	30	214
MC30300	300	30	316
MC30400	400	30	416
MC30450	450	30	466
MC30500	500	30	516

## Cable capacities:

MC30			APPROX CABLE CAPACITY UNDER NEC 50% RULE		
CABLE TRAY	TOTAL FILL AREA (mm <sup>2</sup> )	NEC 50% RULE: ALLOWABLE FILL AREA (mm <sup>2</sup> )	CAT 5e 4-pr UTP (4.9mm diam)	CAT 6 4-pr UTP (6.5mm diam)	CAT 6a 4-pr UTP (8.9mm diam)
MC3050	1400	700	37	21	11
MC30100	2800	1400	74	42	23
MC30150	4200	2100	111	63	34
MC30200	5600	2800	148	84	45
MC30300	8400	4200	223	127	68

## Finishes:

EZ - Electro-Zinc  
HDG - Hot-dip Galvanised

PG - Pre-Galvanised  
PC - Powder Coated

# Technical Data Sheet

## Product Code:

MC55 Range

## Product Description:

55mm high steel wire cable tray  
50 x 100 mm mesh configuration

## Product Dimensions:

MC5550 - 55 x 50 mm  
MC55100 - 55 x 100 mm  
MC55150 - 55 x 150 mm  
MC55200 - 55 x 200 mm  
MC55300 - 55 x 300 mm  
MC55400 - 55 x 400 mm  
MC55450 - 55 x 450 mm  
MC55500 - 55 x 500 mm  
MC55600 - 55 X 600 mm

Standard 3 metres length

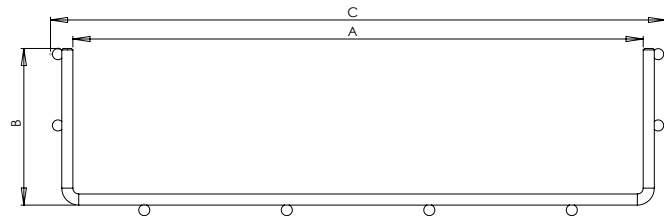
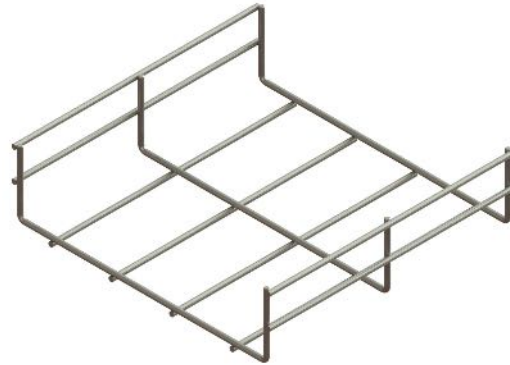

## Applicable Standards:

BS EN 61537 (Cable tray systems)  
BS EN ISO 10244 (Steel wire and wire products)  
BS EN ISO 1461 (Hot dip galvanized coatings)  
BS EN ISO 2081 (Metallic and other inorganic coatings)  
BS EN 13438 (Powder organic coatings)

## Product Specification:

Manufactured: Machine welded from steel wire rod

PART CODE	'A' DIMENSION	'B' DIMENSION	'C' DIMENSION
MC5550	50	55	64
MC55100	100	55	114
MC55150	150	55	164
MC55200	200	55	214
MC55300	300	55	316
MC55400	400	55	418
MC55450	450	55	468
MC55500	500	55	518
MC55600	600	55	618

## Cable capacities:

MC55			APPROX CABLE CAPACITY UNDER NEC 50% RULE		
CABLE TRAY	TOTAL FILL AREA (mm <sup>2</sup> )	NEC 50% RULE: ALLOWABLE FILL AREA (mm <sup>2</sup> )	CAT 5e 4-pr UTP (4.9mm diam)	CAT 6 4-pr UTP (6.5mm diam)	CAT 6a 4-pr UTP (8.9mm diam)
MC5550	2600	1300	69	39	21
MC55100	5200	2600	138	78	42
MC55150	7800	3900	207	118	63
MC55200	10400	5200	276	157	84
MC55300	15600	7800	414	235	125
MC55400	20800	10400	552	313	167
MC55450	23400	11700	620	353	188
MC55500	26000	13000	689	392	209
MC55600	31200	15599.95	827	470	251

## Finishes:

EZ - Electro-Zinc  
HDG - Hot-dip Galvanised

PG - Pre-Galvanised  
PC - Powder Coated

# Technical Data Sheet

## Product Code:

MC106 Range

## Product Description:

106mm high steel wire cable tray  
50 x 100 mm mesh configuration

## Product Dimensions:

MC106100 - 106 x 100 mm  
MC106150 - 106 x 150 mm  
MC106200 - 106 x 200 mm  
MC106300 - 106 x 300 mm  
MC106400 - 106 x 400 mm  
MC106450 - 106 x 450 mm  
MC106500 - 106 x 500 mm  
MC106600 - 106 x 600 mm

Standard 3 metres length

## Applicable Standards:

BS EN 61537 (Cable tray systems)  
BS EN ISO 10244 (Steel wire and wire products)  
BS EN ISO 1461 (Hot dip galvanized coatings)  
BS EN ISO 2081 (Metallic and other inorganic coatings)  
BS EN 13438 (Powder organic coatings)

## Product Specification:

Manufactured: Machine welded from steel wire rod

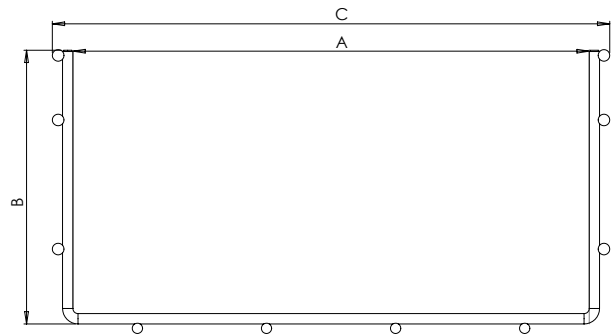
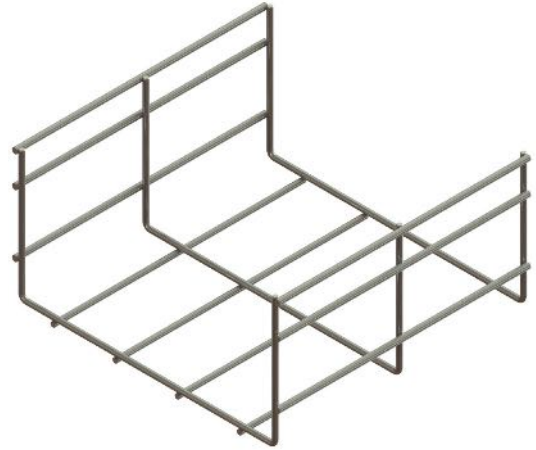

PART CODE	'A' DIMENSION	'B' DIMENSION	'C' DIMENSION
MC106100	100	106	114
MC106150	150	106	164
MC106200	200	106	214
MC106300	300	106	316
MC106400	400	106	418
MC106450	450	106	468
MC106500	500	106	518
MC106600	600	106	618

## Cable capacities:

MC30		APPROX CABLE CAPACITY UNDER NEC 50% RULE			
CABLE TRAY	TOTAL FILL AREA (mm <sup>2</sup> )	NEC 50% RULE: ALLOWABLE FILL AREA (mm <sup>2</sup> )	CAT 5e 4-pr UTP (4.9mm diam)	CAT 6 4-pr UTP (6.5mm diam)	CAT 6a 4-pr UTP (8.9mm diam)
MC106100	10303	5152	273	155	83
MC106150	15452	7726	410	233	124
MC106200	20600	10300	546	310	166
MC106300	30903	15452	819	466	248
MC106400	41200	20600	1092	621	331
MC106450	46348	23174	1229	698	373
MC106500	51503	25752	1366	776	414
MC106600	617800	30900	1639	931	497

## Finishes:

EZ - Electro-Zinc

HDG - Hot-dip Galvanised

PG - Pre-Galvanised

PC - Powder Coated