

ITEM NO.	DESCRIPTION	QTY.			
1	Z-PLUG MODULE	1	1	1	1
2	LACING/TERMINATION MODULE	1	1	1	1
3	BOOT/STRAIN RELIEF	1	1	1	1
4	LATCH PROTECTOR	1	1	-	-
-	INSTRUCTION DOCUMENT	1/50	1/100	1/50	1/100
-	Z-TOOL-ZP	1/50	1/100	1/50	1/100
		ZP1-6AS-01S	ZP1-6AS-01B	ZP1-6AS-00S	ZPA-6AS-00B

REVISIONS					
REV.	ZCN/ECO	DESCRIPTION	BY	DATE	APPROVED
A	ECR-5411	NEW RELEASE	JH	11/21/2017	DG 11/22/2017
B	ECR-5499	B1: RELOCATED DATE CODE TO SIDE OF PLUG	JH	03/07/2018	DG 03/07/2018

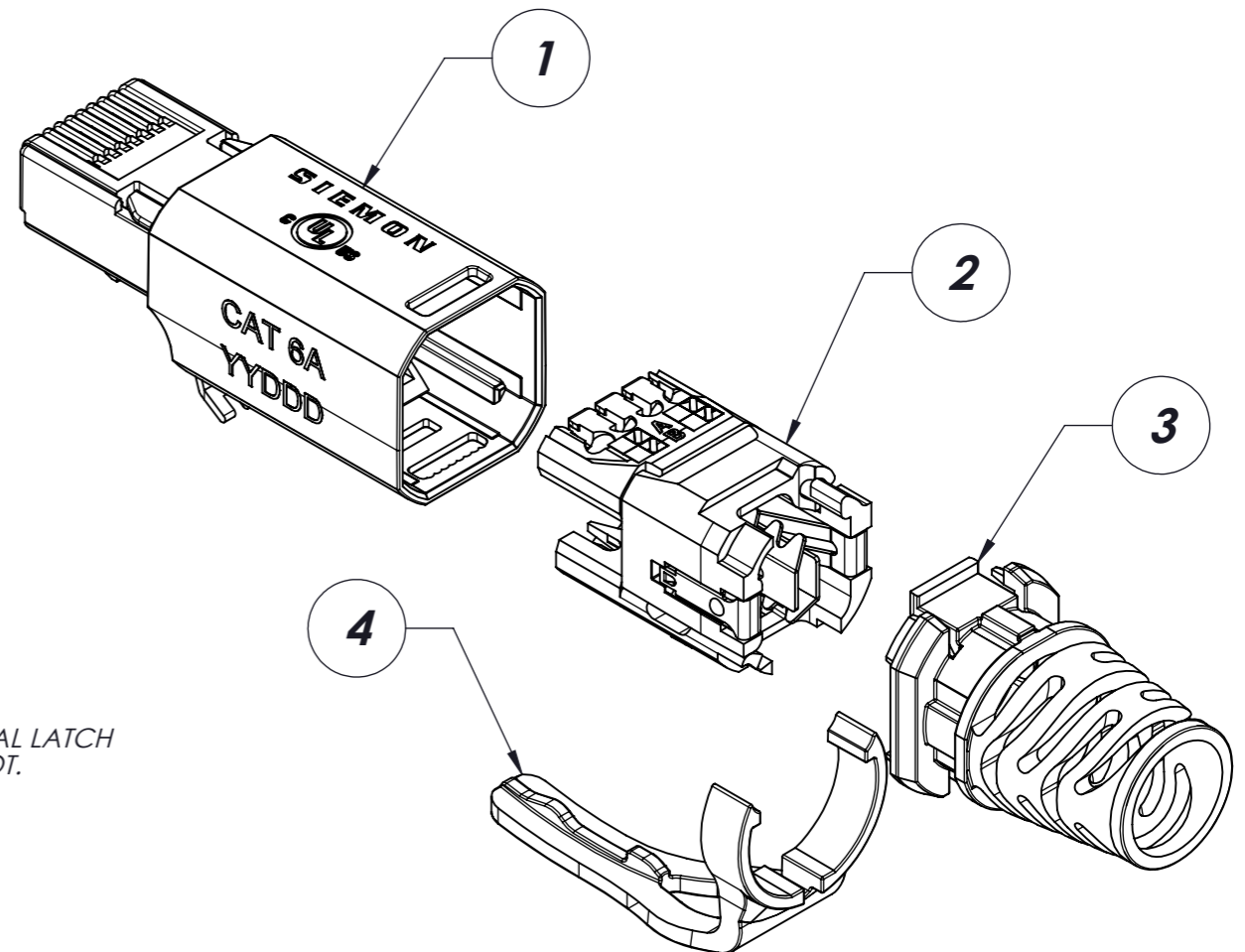
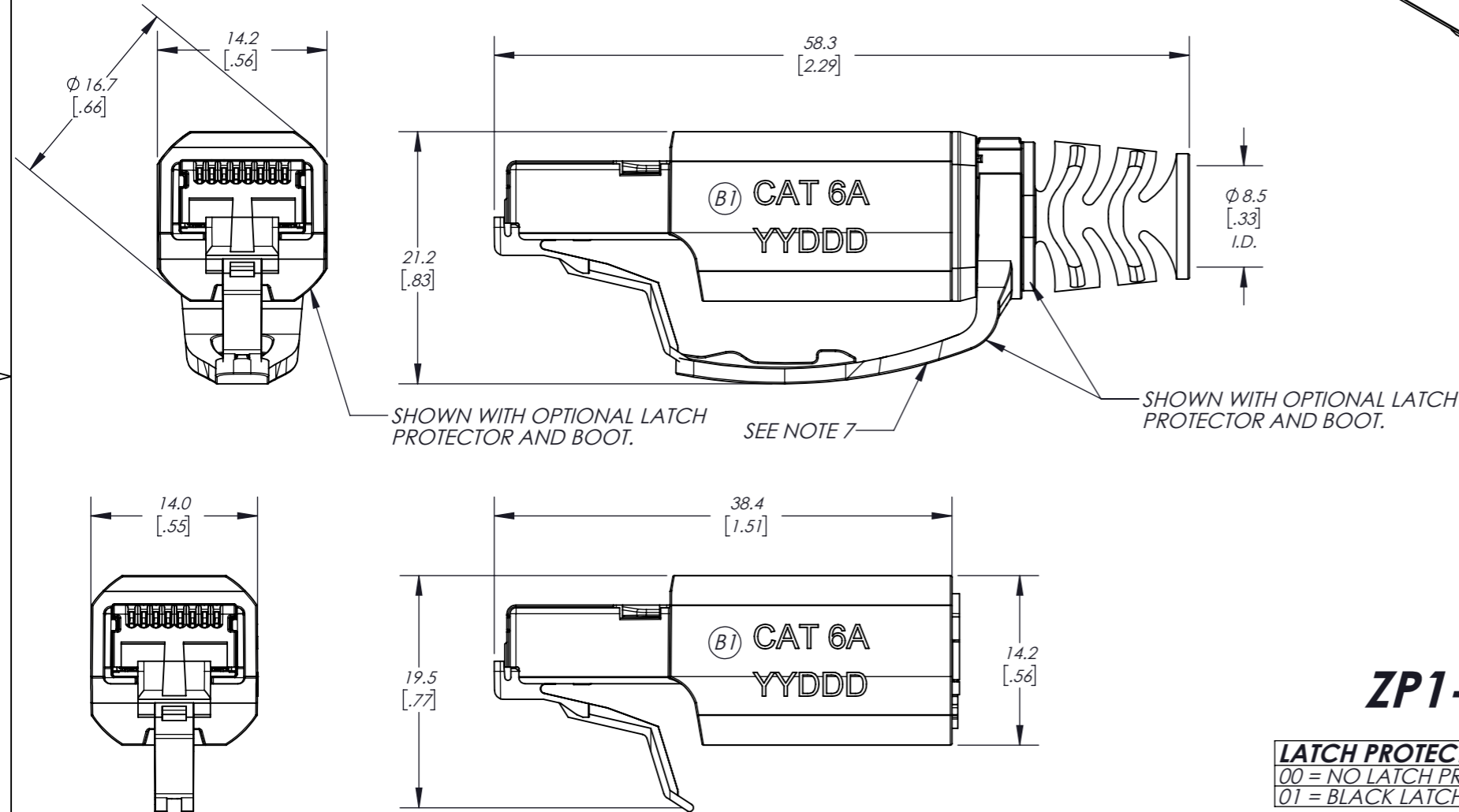

ZP1-6AS-(XX)(X)

LATCH PROTECTOR, ITEM 4
 00 = NO LATCH PROTECTOR
 01 = BLACK LATCH PROTECTOR

S = STANDARD PACK
 B = BULK PACK

- NOTES:
- MATERIALS: FLAME RETARDANT THERMOPLASTIC;
 FRONT CONTACTS: COPPLY ALLOY PLATED WITH 1.27 MICRON [50 MICRO INCHES] MINIMUM THICK GOLDOR EQUIVALENT AT CONTACT INTERFACE;
 IDC: COPPER ALLOY PLATED WITH 0.76 MICRON [30 MICRO INCHES] MINIMUM THICK TIN;
 GROUND CLIPS: STAINLESS STEEL.
 - LISTED PER UL 1863 AND APPROVED PER CSA 22.2.
 - REFERENCE PRODUCT INSTRUCTIONS FOR USE OF PRODUCT.
 - TRANSMISSION PROPERTIES MEET OR EXCEED ALL TIA, ISO/IEC, AND IEC PERFORMANCE REQUIREMENTS FOR CATEGORY 6 OR CATEGORY 6A AS APPLICABLE.
 - PLEASE REFERENCE APPLICABLE SIEMON SPECIFICATION SHEET FOR TECHNICAL PERFORMANCE DATA AND RELEVANT INDUSTRY STANDARDS COMPLIANCE.
 - CONTACT A SIEMON COMPANY CUSTOMER SERVICE REPRESENTATIVE FOR ADDITIONAL INFORMATION.
 - COLOR CODING LATCH PROTECTOR P/N ZP-CLIP-(XX). CONTACT CUSTOMER SERVICE TO ORDER.

PROPRIETARY INFORMATION <small>THIS DOCUMENT CONTAINS PROPRIETARY INFORMATION OF THE SIEMON COMPANY AND IS DELIVERED ON THE EXPRESSED CONDITIONS THAT IT IS NOT TO BE DISCLOSED OR REPRODUCED IN WHOLE OR PART, OR USED FOR MANUFACTURING FOR ANYONE OTHER THAN THE SIEMON COMPANY WITHOUT ITS WRITTEN CONSENT AND THAT NO RIGHT IS GRANTED TO DISCLOSE OR SO USE ANY INFORMATION CONTAINED IN SAID DOCUMENT.</small>	THE SIEMON COMPANY 101 SIEMON COMPANY DRIVE WATERTOWN, CT 06795 (860) 945-4200 www.siemon.com		TITLE <h3>Z-PLUG FIELD TERMINATED RJ45</h3>	
	TOLERANCES 0 [.0] ±1 [±.04] .0 [.00] ±0.5 [±.02] .00 [.000] ±0.25 [±.01]		DRAWN BY: J. HARRIS DATE: 2017-11-21	DWG. SIZE: B DWG. NO.: M-9079200
	ANGLE ±1° ANSI Y14.5M-1982 OR ISO 1101, 129 & 3040		CHECKED BY: D. GIAMPIETRO DATE: 2017-11-28	PART NO.: ZP1-6AS-(XX)(X) REV.: B
	PRIMARY DIMENSIONS ARE MILLIMETERS DIMENSIONS IN BRACKETS [] ARE INCHES DO NOT SCALE		ENGINEER: J. HARRIS DATE: 2017-11-21	SCALE: 2:1 SHEET 1 OF 1

CUSTOMER USE DRAWING