

UK PVC CABLE TRAY CATALOGUE



DIETZEL
UNIVOLT

3E Basor
CABLE TRAY SPECIALIST

CABLE MANAGEMENT ALLIANCE

EDITION 4 (2022)

Water Treatment



Tertiary Buildings



Petrochemical Industry



Petrochemical Industry



Solar Installations





BASORPLAST

BPE

PVC Cable Trays & Accessories.....Page 4
PVC Installation guide.....Page 7

CONTACT US

Mail: sales@univolt.co.uk
Phone: 01707379820

PVC Cable trays Applications

**WATER
TREATMENT
WORKS**

**PETROCHEMICAL
INDUSTRY**

**RAILWAY
INFRASTRUCTURES**

**COASTAL
APPLICATIONS**

**CHEMICAL
INDUSTRY**



ES 2376



PVC UV
corrosion
resistant trays for
**EXTERNAL
APPLICATION**

Basorplast BPE

PVCM1 UV Cable Trays

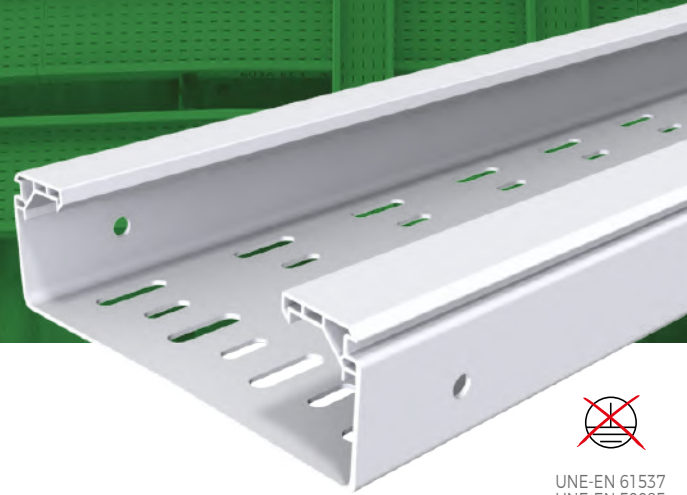

TECHNICAL DATA SHEET

Models (HxW):

60x100; 60x150; 60x200; 60x300; 100x200; 100x300; 100x400; 100x600.

Types: Slotted or solid bottom

Finishes PVC UVM1 RAL 7035

Characteristics of the tray:

- Non metallic system
- Resistant to UV radiation UL568
- Excellent behaviour in outdoor
- Impact strength: 20j except 60x100 with 10j
- Minimum temperature
- Maximum temperature
- Non-Flame propagating
- No electrical continuity
- Insulating
- Dielectric Strength
- High resistance to corrosion substances (DIN 8061 & ISO/TR 10358)
- M1 reaction to fire: UNE 23727
- Glow wire test: 1760°F (960°C) EN 60695-2-11
- Flammability: UL 94-VO, ANSI/UL 94-1995
- LOI > 50% EN ISO 4589
- Comply: RoHS 2011/65/UE
- Raw material without silicone



Available on basor.com

INSTRUCTIONS FOR USE

Assembly: H60 (2 union joints + 4 bolts) H100 (2 coupler joints + 8 bolts).

Installation: Not allowed under other conduction system such as water, vapour or gas.

Ventilation: Minimum distance between each tray of 250 mm.

Enviroments: Wet, salty and chemical.

Expansions: Depending of the expected growth in the temperature (AT) leave a gap (h) between cable trays according to the following table:

Expected Temp. Growth		GAP
ΔT (°F)	ΔT (°C)	h (mm)
36	20	5
54	30	7
72	40	9
90	50	11

UNE-EN 61537
UNE-EN 50085

SAFE WORKING LOADS: RECOMMENDATION

MODELS	IEC 61537 SWL (CTA) kg/m (lb/ft)							
	Temp. Max 40°C (104°F)				Temp. Max 60°C (140°F)			
	1 m span (Vano)		1,5 m span (Vano)		1 m span (Vano)		1,5 m span (Vano)	
	Kg/m	Lb/ft	Kg/m	Lb/ft	Kg/m	Lb/ft	Kg/m	Lb/ft
BPE-60X100	38	26	24	16	28	19	10	7
BPE-60X150	39	26	25	17	30	20	12	8
BPE-60X200	67	45	38	26	36	24	16	11
BPE-60X300	74	50	45	30	40	27	21	14
BPE-100X200	121	81	77	52	62	42	34	23
BPE-100X300	123	83	89	56	75	50	38	26
BPE-100X400	178	120	102	68	88	79	48	32
BPE-100X600	212	142	121	81	108	73	58	39

NOTE: Tests according to IEC 61537 (limited deflection) Type Iii test, with 1,7 Safety factor



UNE-EN IEC 61537
UNE-EN 50085
UNE 23727
UL94



UNE-EN 60695



UNE-EN 61537



UNE-EN 50085



ISO/TR 10358
DIN 8061

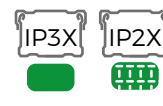

IEC 60529



Mod. 60x100 10J
UNE-EN 61537
UNE-EN 50085

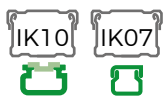

IEC 50102

Basorplast BPE

PVC CABLE TRAYS

BPE-P / H60



Univolt Part Code		
	Description	Pack QTY
BPE60X100PVC	BPE 60X100	6 m
BPE60X150PVC	BPE 60X150	6 m
BPE60X200PVC	BPE 60X200	6 m
BPE60X300PVC	BPE 60X300	6 m



COVER TBPE



Univolt Part Code		
	Description	Pack QTY
TBPE100/P/PVC	TBPE 100	6 m
TBPE150/P/PVC	TBPE 150	6 m
TBPE200/P/PVC	TBPE 200	6 m
TBPE300/P/PVC	TBPE 300	6 m
TBPE400/P/PVC	TBPE 400	6 m
TBPE600/P/PVC	TBPE 600	6 m



BPE-P / H100



Univolt Part Code		
	Description	Pack QTY
BPE100X200PVC	BPE 100X200	6 m
BPE100X300PVC	BPE 100X300	6 m
BPE100X400PVC	BPE 100X400	6 m
BPE100X600PVC	BPE 100X600	6 m



END COVER TFBPE



Univolt Part Code		
	Description	Pack QTY
TFBPE60X100PVC	TFBPE 60X100	1 ea
TFBPE60X150PVC	TFBPE 60X150	1 ea
TFBPE60X200PVC	TFBPE 60X200	1 ea
TFBPE60X300PVC	TFBPE 60X300	1 ea
TFBPE100X200PVC	TFBPE 100X200	1 ea
TFBPE100X300PVC	TFBPE 100X300	1 ea
TFBPE100X400PVC	TFBPE 100X400	1 ea
TFBPE100X600PVC	TFBPE 100X600	1 ea



FLAT BEND 90° CPBPE



Univolt Part Code		
	Description	Pack QTY
CPBPE60X100PVC	CPBPE 60X100	1 ea
CPBPE60X150PVC	CPBPE 60X150	1 ea
CPBPE60X200PVC	CPBPE 60X200	1 ea
CPBPE60X300PVC	CPBPE 60X300	1 ea
CPBPE100X200PVC	CPBPE 100X200	1 ea
CPBPE100X300PVC	CPBPE 100X300	1 ea
CPBPE100X400PVC	CPBPE 100X400	1 ea
CPBPE100X600PVC	CPBPE 100X600	1 ea



COVER FLAT BEND TCPBPE



Univolt Part Code		
	Description	Pack QTY
TCPBPE100PVC	TCPBPE 100	1 ea
TCPBPE150PVC	TCPBPE 150	1 ea
TCPBPE200PVC	TCPBPE 200	1 ea
TCPBPE300PVC	TCPBPE 300	1 ea
TCPBPE400PVC	TCPBPE 400	1 ea
TCPBPE600PVC	TCPBPE 600	1 ea



INSIDE BEND CCBPE



Univolt Part Code		
	Description	Pack QTY
CCBPE60X100PVC	CCBPE 60X100	1 ea
CCBPE60X150PVC	CCBPE 60X150	1 ea
CCBPE60X200PVC	CCBPE 60X200	1 ea
CCBPE60X300PVC	CCBPE 60X300	1 ea
CCBPE100X200PVC	CCBPE 100X200	1 ea
CCBPE100X300PVC	CCBPE 100X300	1 ea
CCBPE100X400PVC	CCBPE 100X400	1 ea
CCBPE100X600PVC	CCBPE 100X600	1 ea



COVER INSIDE BEND TCCBPE



Univolt Part Code		
	Description	Pack QTY
TCCBPE60X100PVC	TCCBPE 60X100	1 ea
TCCBPE60X150PVC	TCCBPE 60X150	1 ea
TCCBPE60X200PVC	TCCBPE 60X200	1 ea
TCCBPE60X300PVC	TCCBPE 60X300	1 ea
TCCBPE100X200PVC	TCCBPE 100X200	1 ea
TCCBPE100X300PVC	TCCBPE 100X300	1 ea
TCCBPE100X400PVC	TCCBPE 100X400	1 ea
TCCBPE100X600PVC	TCCBPE 100X600	1 ea



Basorplast BPE

PVC CABLE TRAYS

OUTSIDE BEND CXBPE



Univolt Part Code	Description	Pack QTY
CXBPE60X100PVC	CXBPE 60X100	1 ea
CXBPE60X150PVC	CXBPE 60X150	1 ea
CXBPE60X200PVC	CXBPE 60X200	1 ea
CXBPE60X300PVC	CXBPE 60X300	1 ea
CXBPE100X200PVC	CXBPE 100X200	1 ea
CXBPE100X300PVC	CXBPE 100X300	1 ea
CXBPE100X400PVC	CXBPE 100X400	1 ea
CXBPE100X600PVC	CXBPE 100X600	1 ea



COVER OUTSIDE BEND TCXBPE



Univolt Part Code	Description	Pack QTY
TCXBPE60X100PVC	TCXBPE 60X100	1 ea
TCXBPE60X150PVC	TCXBPE 60X150	1 ea
TCXBPE60X200PVC	TCXBPE 60X200	1 ea
TCXBPE60X300PVC	TCXBPE 60X300	1 ea
TCXBPE100X200PVC	TCXBPE 100X200	1 ea
TCXBPE100X300PVC	TCXBPE 100X300	1 ea
TCXBPE100X400PVC	TCXBPE 100X400	1 ea
TCXBPE100X600PVC	TCXBPE 100X600	1 ea



SUPPORT SHG



Univolt Part Code	Description	Pack QTY
SHG100PVC	SHG 100	1 ea
SHG150PVC	SHG 150	1 ea
SHG200PVC	SHG 200	1 ea
SHG300PVC	SHG 300	1 ea
SHG400PVC	SHG 400	1 ea
SHG600PVC	SHG 600	1 ea

SUPPORT SVG



Univolt Part Code	Description	Pack QTY
SVG100PVC	SVG 100	1 ea
SVG150PVC	SVG 150	1 ea
SVG200PVC	SVG 200	1 ea
SVG300PVC	SVG 300	1 ea
SVG400PVC	SVG 400	1 ea
SHVG600PVC	SVG 600	1 ea

COUPLERS & SCREWS



Univolt Part Code	Description	Pack QTY
JUPBE-60	JUBPE 60	10 ea
JUPBE-100	JUBPE 100	10 ea
CTBP-100PVC	CTBP-100	100 ea



HINGED JOINTS



Univolt Part Code	Description	Pack QTY
JUPBEAB-60	JUBPE-AB 60	1 kit
JUPBEAB-100	JUBPE-AB 100	1 kit



BRIDLE IK BIK10



Univolt Part Code	Description	Pack QTY
BIK60X100	BIK10-BPE 60X100	10 ea
BIK60X150	BIK10-BPE 60X150	10 ea
BIK60/100X200	BIK10-BPE 60/100X200	10 ea
BIK60/100X300	BIK10-BPE 60/100X300	10 ea
BIK100X400	BIK10-BPE 100X400	10 ea
BIK100x600	BIK10-BPE 100X600	10 ea



PROFILES AND HEAD PROFILES



Univolt Part Code	Description	Pack QTY
PSHG2M	PSHG 2M	2 m
PSHGR600	PSHGR 600	2 ea
TFSHGRPVC	TFSHGR PVC	1 ea
KSHGR	KSHGR	1 ea
CT2M10X100	CT2 M10X100	50 ea

TEE/CROSS PDBPE



Univolt Part Code	Description	Pack QTY
PDBPE60PVC	PDBPE 60	1 ea
PDBPE100PVC	PDBPE 100	1 ea



DIVIDER PROFILE PSBPE



Univolt Part Code	Description	Pack QTY
PSBPE60PVC	PSBPE 60	30 m
PSBPE100PVC	TPSBPE 100	30 m



PVC Trays
installation
guide 2022

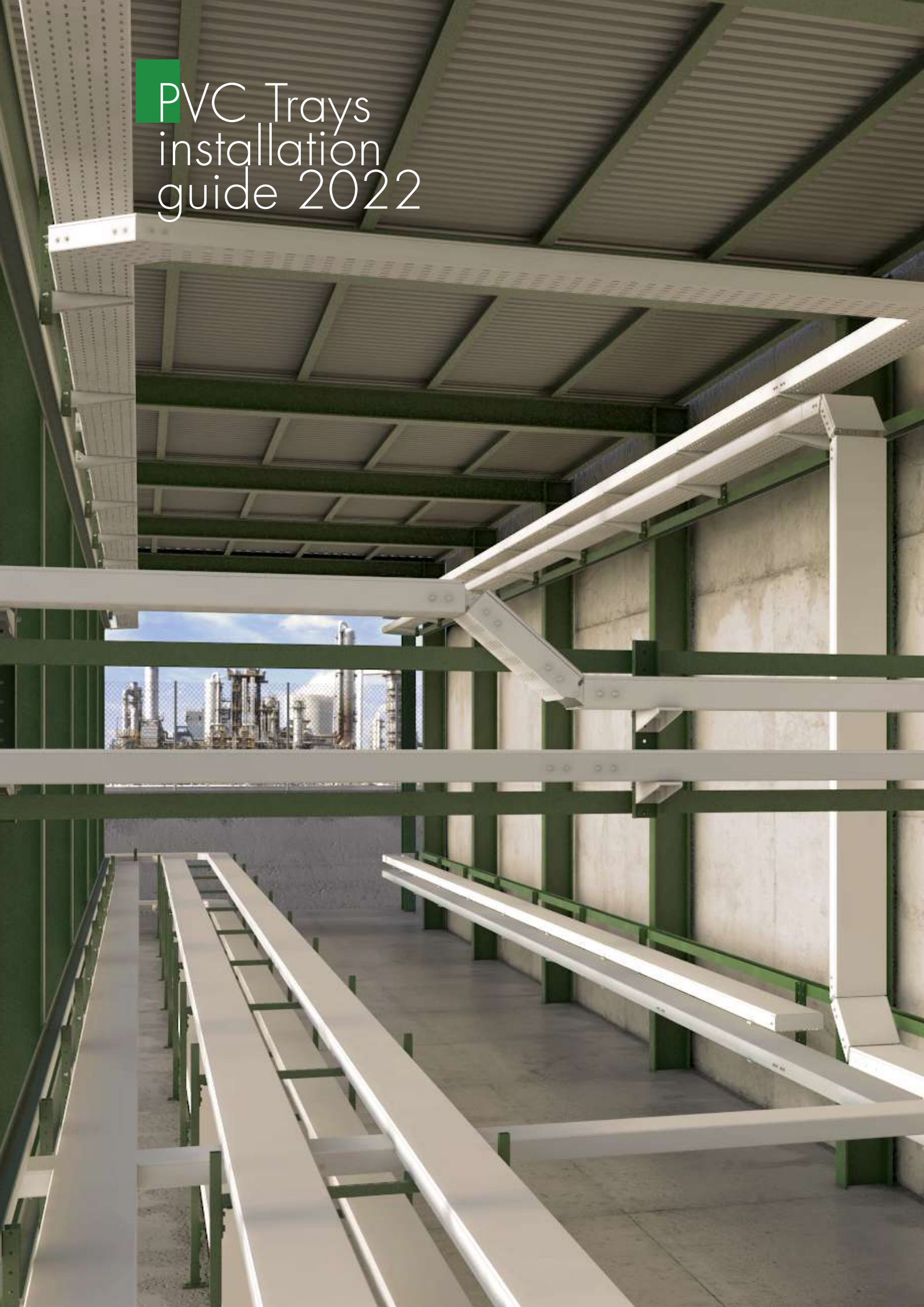

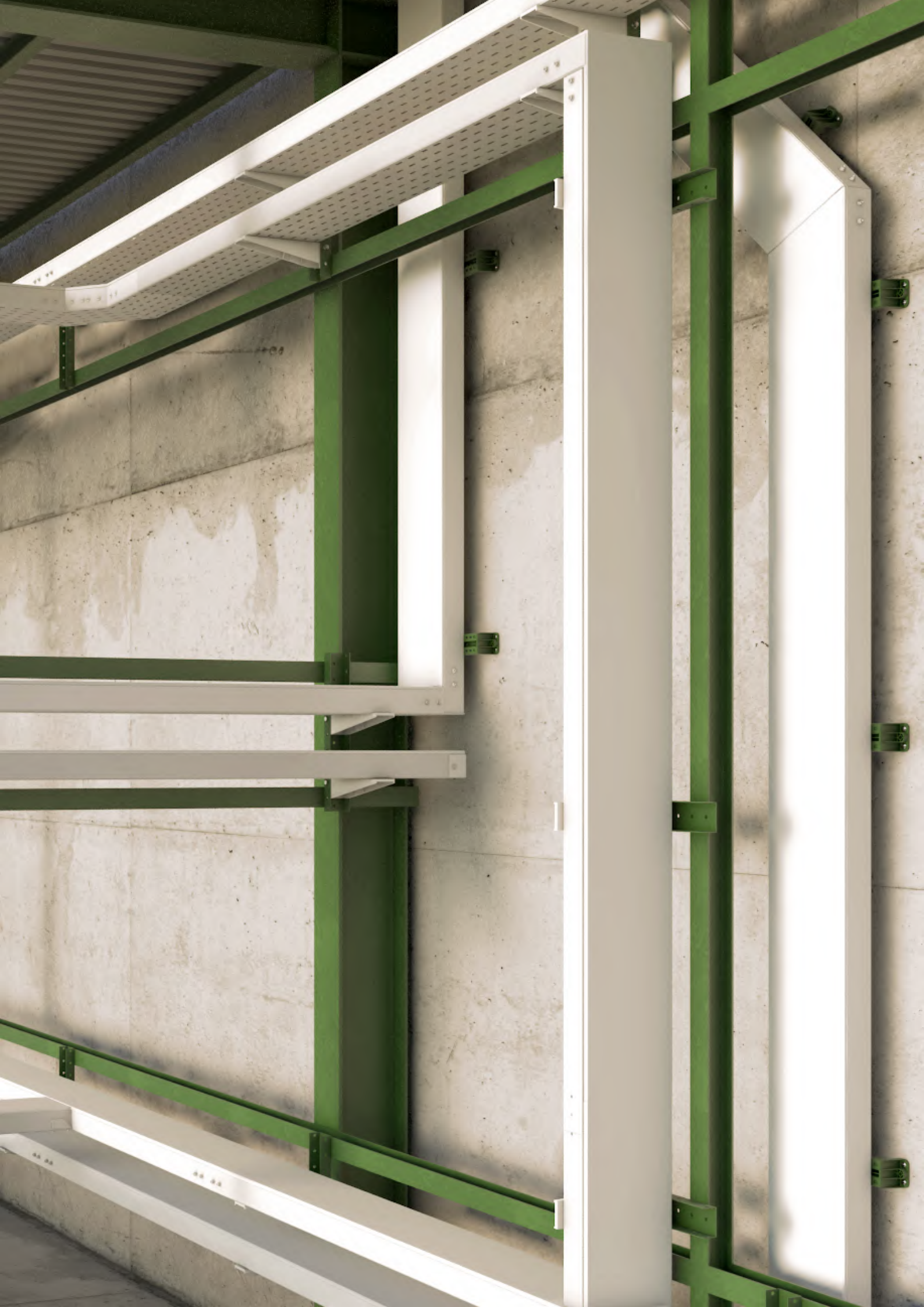

Cutting

Basorplast cable tray is made from a PVC material that can be cut using a standard hand cutting saw with a fine-tooth cutting blade.

Lightly sand any rough surfaces for optimum results.

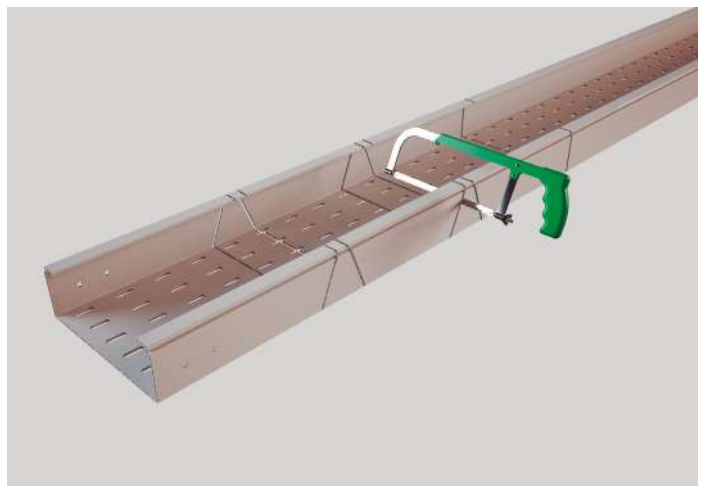
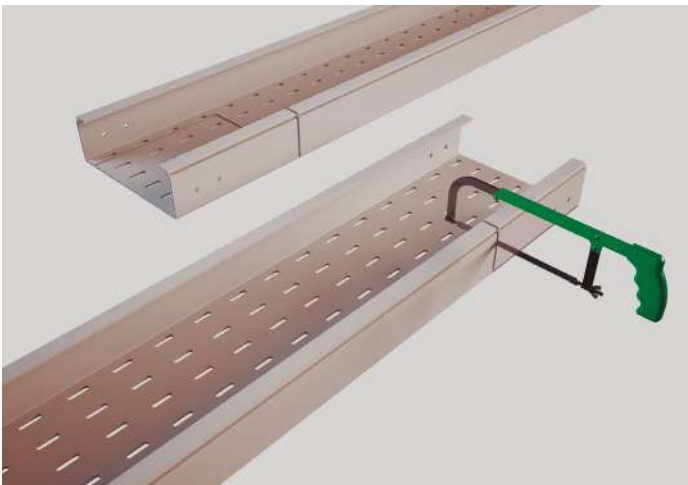
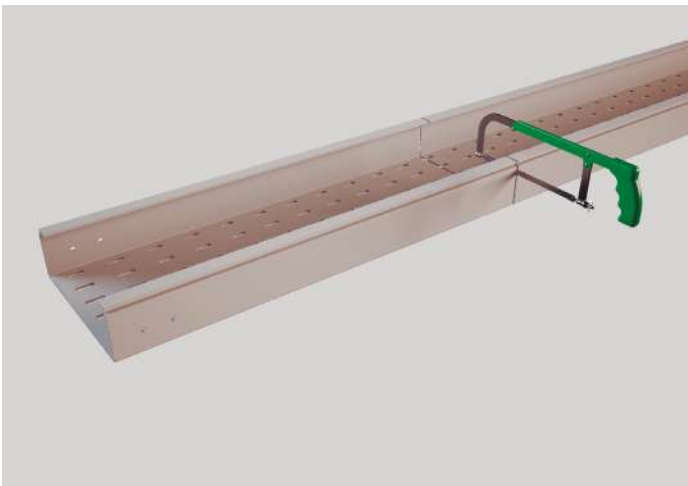

Tools and mounting accessories

Mounting accessories



Screws and nuts:
PVC sets of screws and nuts for all the list of union joints (210017).



Standard union joint:
Straight PVC union joint available for high 60 (210084) and high 100 (210085).



Vertical union joint:
Articulated PVC union joint available for high 60 (223613) and high 100 (223614).



Horizontal union joint:
Mobile PVC union joint available for high 60 (223613) and high 100 (223614).



PVC derivation Piece:
Angle made of PVC for high 60 (223021) and high 100 (223022).

Tools



Electric Drill:
Use an electric drill machine and a borer to drill (of the n°8)



Cutting saw:
Use an standard cutting saw for PVC materials.



De-Burr Machine:
Use an small hand re-burr cutter for all materials.

Straight Junctions

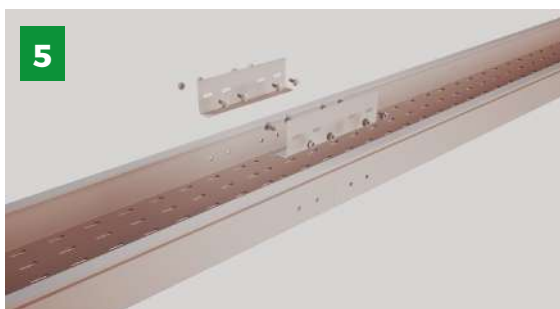
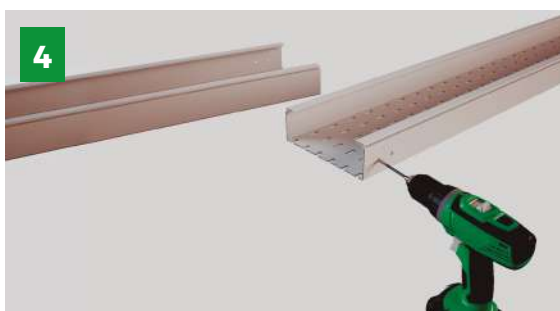
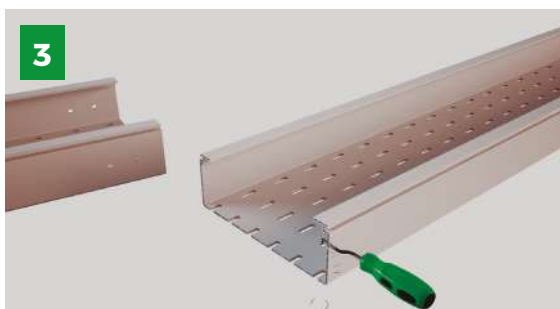
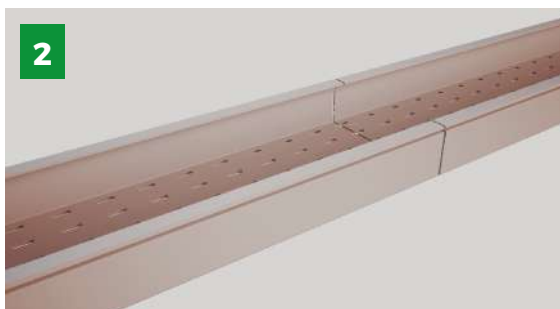
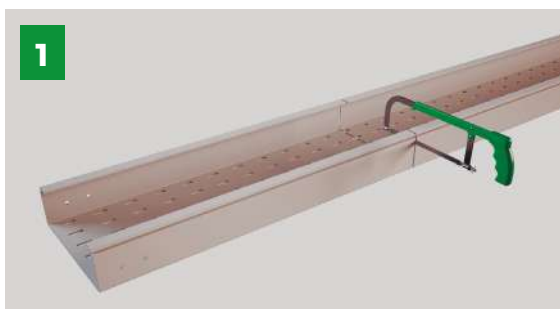

INSTRUCTIONS

1. Cut the tray piece with the cutting saw into 2 pieces making a straight cut.
2. Separate the 2 pieces.
3. Remove any rough edges with the de-burring machine.
4. Make 2 holes (for high 60) or 4 holes (for high 100) on each piece with the electric drill.
5. Put 2 union joints JUBPE (210084 for the 60mm height or 210085 for the 100mm) in the correct position and fix the union joints on the tray using 4 screws (for high 60) or 8 screws (for high 100) B2-P (210017).

Horizontal Bends / Small Radius

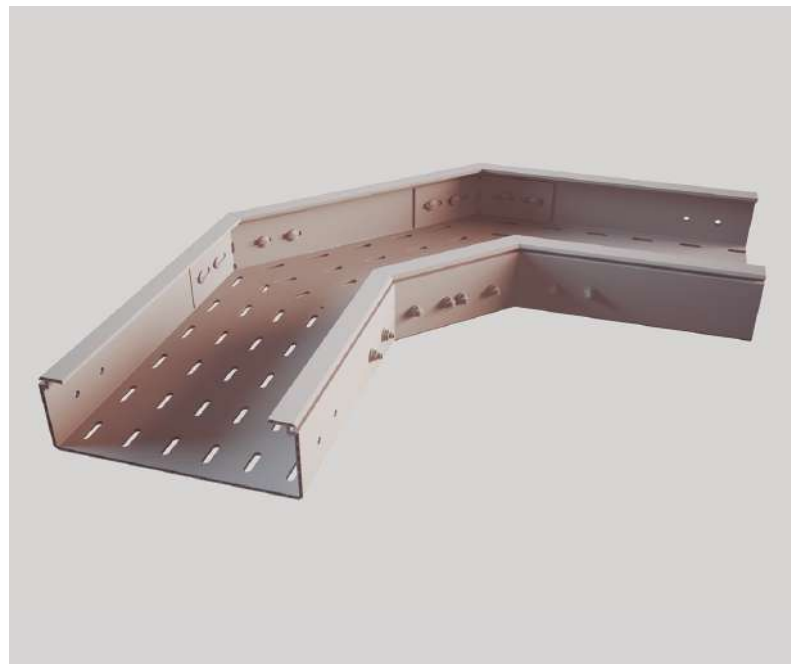
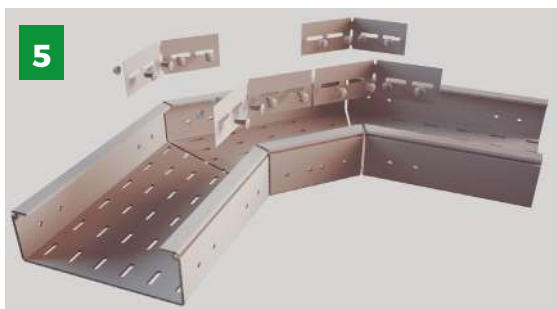
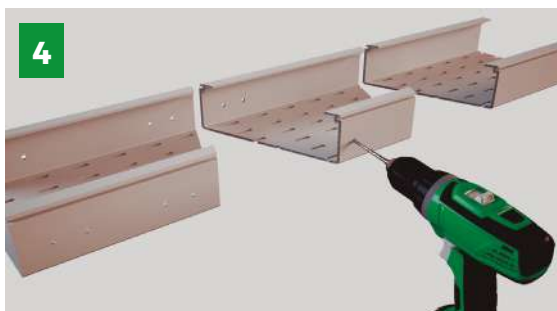
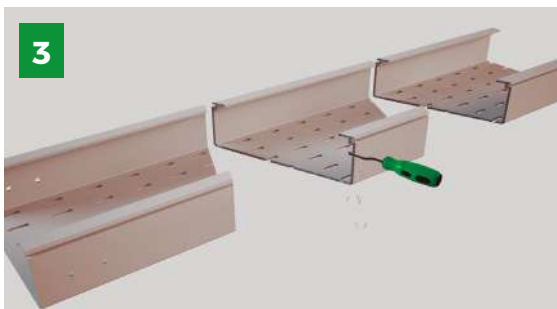
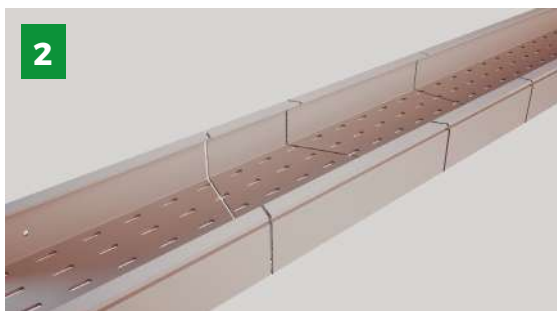

INSTRUCTIONS

1. Cut the tray piece with the cutting saw in 3 pieces making a 45° cut.
2. Separate the 3 pieces.
3. Remove any rough edges with the de-burring machine.
4. Make 8 holes on each piece with the electric drill.
5. Put 4 union joints JUBPE-B (223613 for the 60mm height or 223614 for the 100mm) in the correct position and fix the union joints on the tray using 16 screws B2-P (210017).

Horizontal Bends / Right Radius

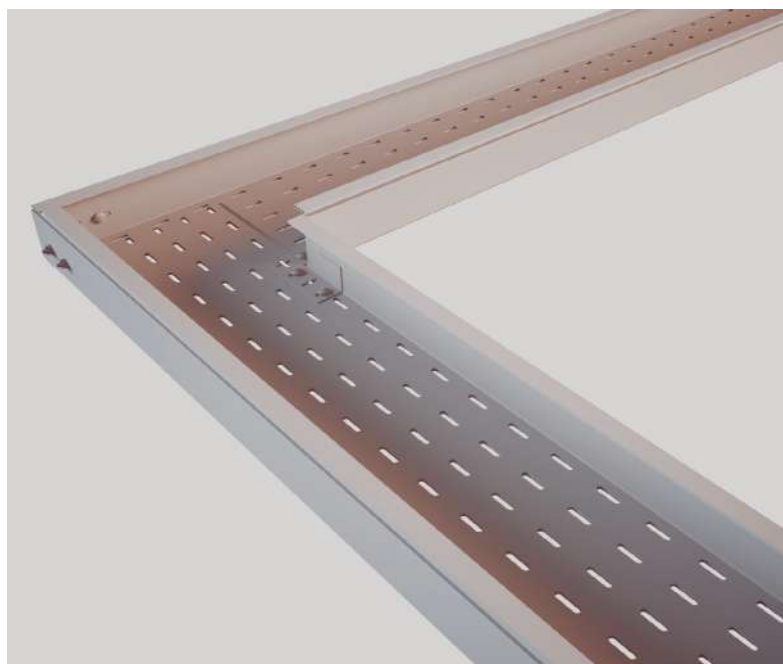
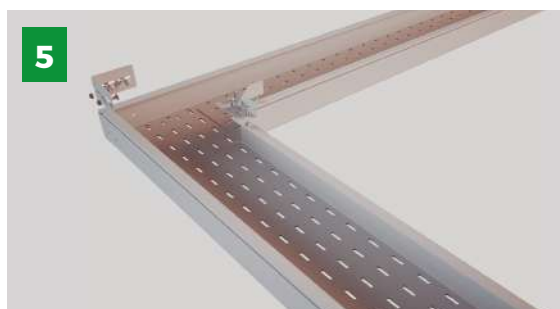
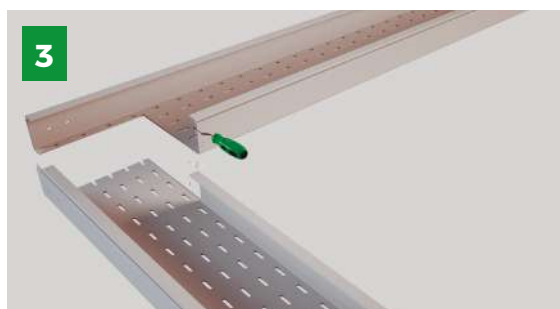
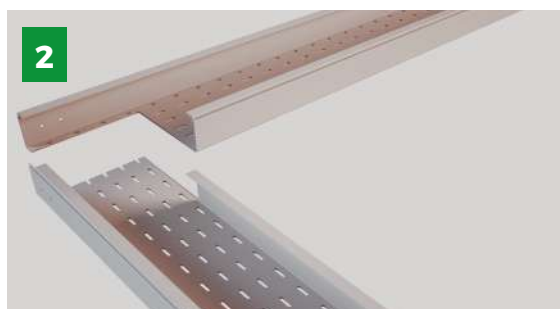
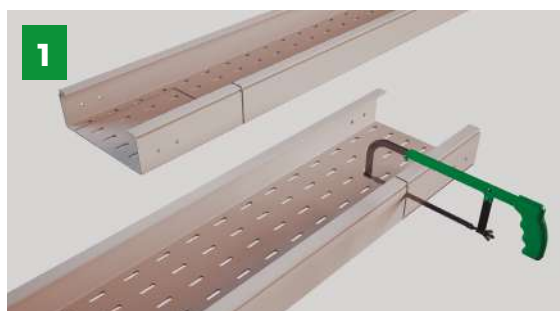

INSTRUCTIONS

1. Cut the tray piece 1 removing the base and cut the tray piece 2 removing the side body, both with the cutting saw.
2. Separate the 2 pieces.
3. Remove any rough edges with the de-burring machine.
4. Make 4 holes on each piece with the electric drill.
5. Put 1 union joint JUBPE-B (223613 for the 60mm height or 223614 for the 100mm) and 1 PDBPE (223021 for the 60mm height or 223022 for the 100mm height) in the correct position and fix the union joints on the tray using 8 screws B2-P (210017).

Horizontal Bends / Large Radius

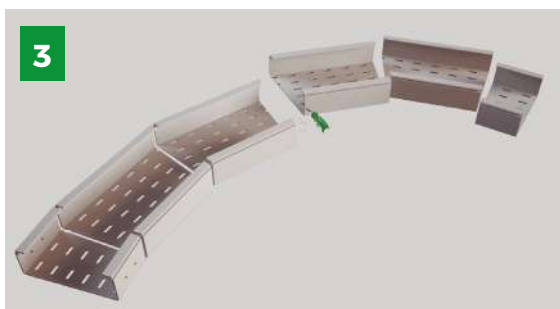
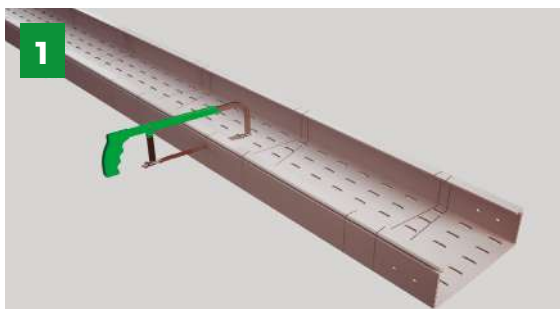

INSTRUCTIONS

1. Cut the tray piece with the cutting saw in 6 pieces making a 45° cut.
2. Separate the 6 pieces.
3. Remove any rough edges with the de-burring machine.
4. Make 4 holes on each piece with the electric drill.
5. Put 10 union joints JUBPE-B (223613 for the 60mm or 223614 for the 100mm) in the correct position and fix the union joints on the tray using 40 screws B2-P (210017).

Horizontal Bends / Other Radius

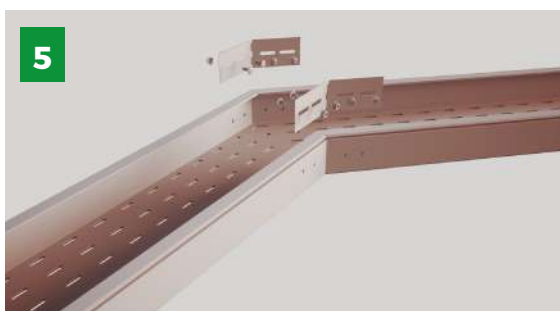
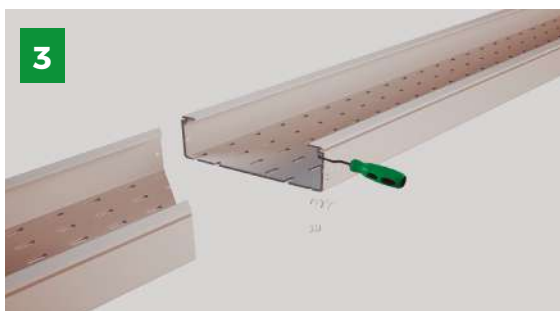

INSTRUCTIONS

1. Cut the tray piece with the cutting saw in 2 pieces making a 45° cut.
2. Separate the 2 pieces.
3. Remove any rough edges with the de-burring machine.
4. Make 4 holes on each piece with the electric drill.
5. Put 2 union joints JUBPE-B (223613 for the 60mm or 223614 for the 100mm) in the correct position and fix the union joints on the tray using 8 screws B2-P (210017).

Inside Bends / Small radius

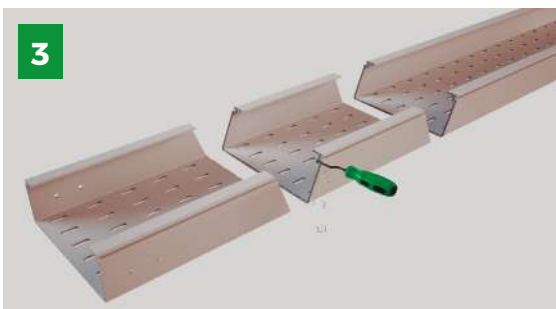
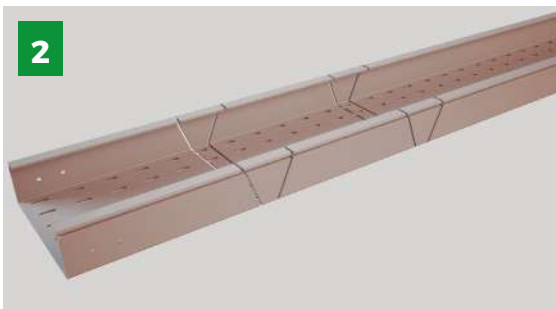
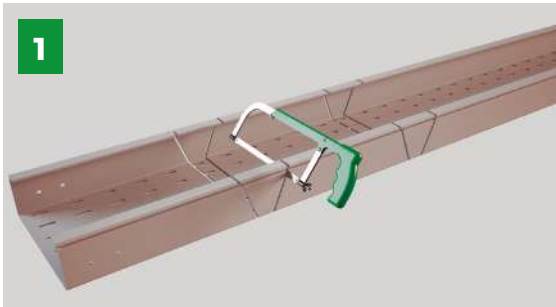

INSTRUCTIONS

1. Cut the tray piece with the cutting saw in 3 pieces making a 45° angle cut.
2. Separate the 3 pieces.
3. Remove any rough edges with the de-burring machine.
4. Make 4 holes on each piece with the electric drill.
5. Put 4 union joints JUBPE-A (223613 for the 60mm or 223614 for the 100mm) in the correct position and fix the union joints on the tray using 16 screws B2-P (210017).

Inside Bends / Right radius

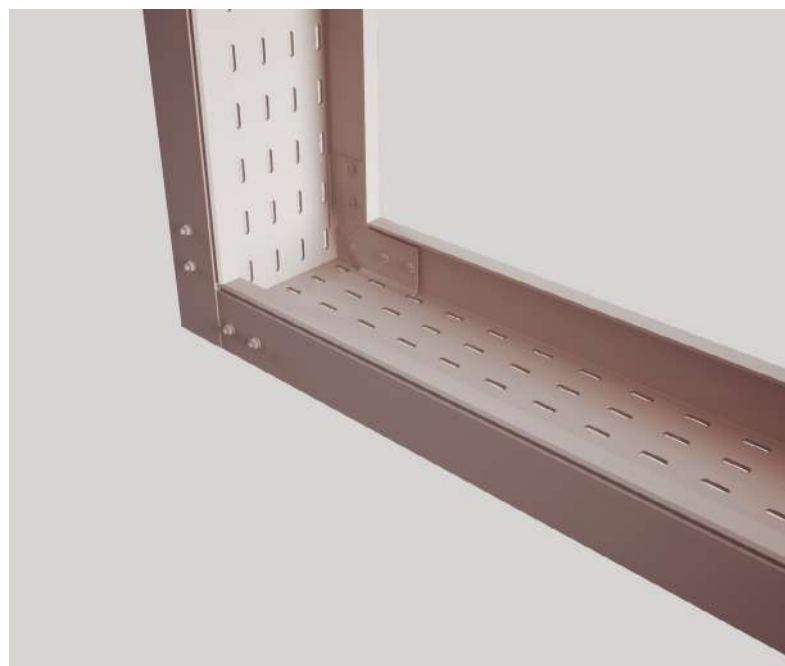
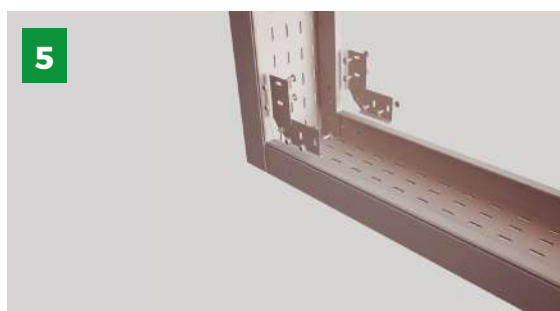
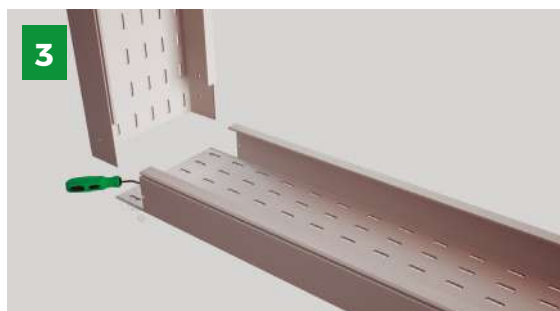
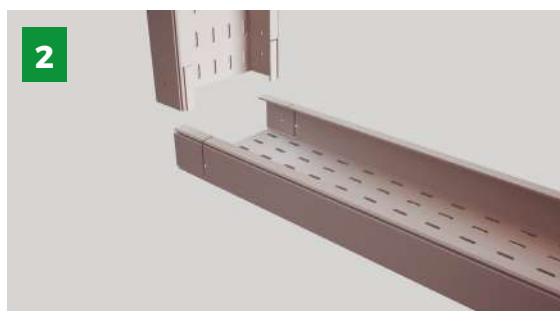
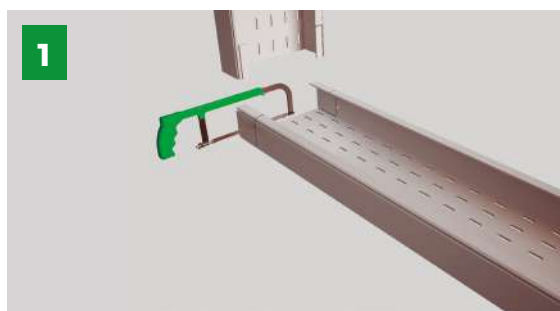

INSTRUCTIONS

1. Cut the tray piece 1 removing the top side body and cut the tray piece 2 removing the side body, both with the cutting saw.
2. Separate the 2 pieces.
3. Remove any rough edges with the de-burring machine.
4. Make 4 holes on each piece with the electric drill.
5. Put 2 union joints JUBPE-A (223613 for the 60mm or 223614 for the 100mm) in the correct position and fix the union joints on the tray using 8 screws B2-P (210017).

Inside Bends / Large radius

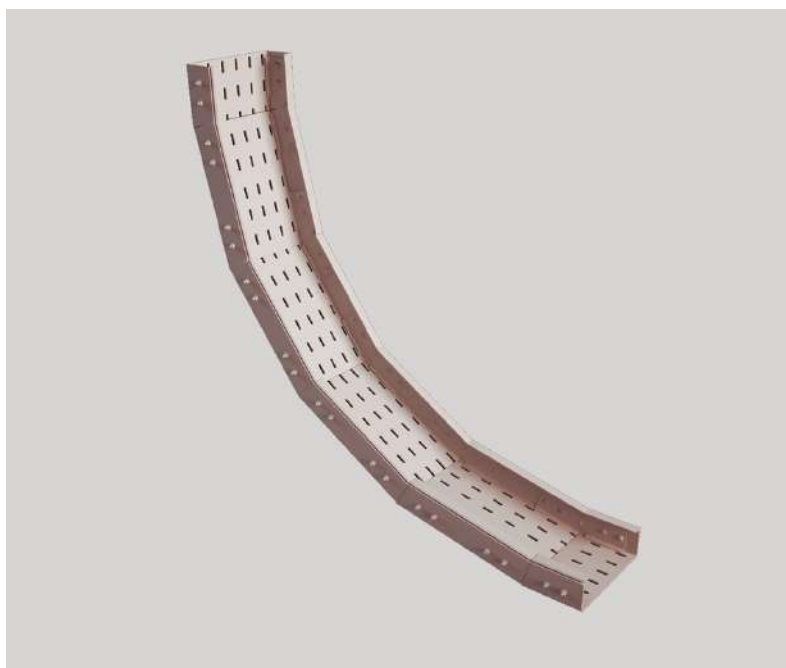
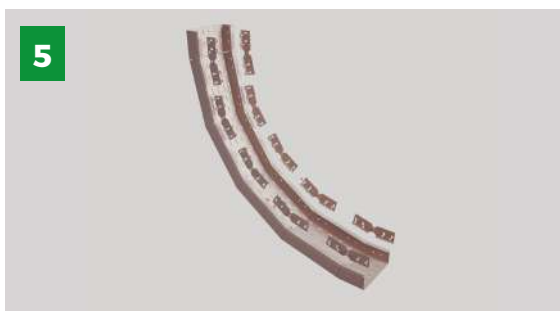
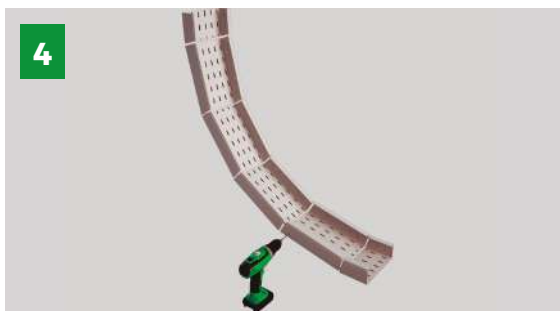
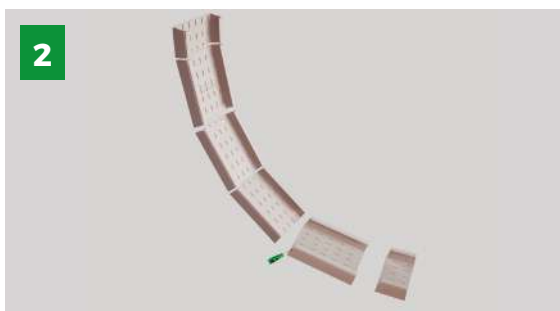
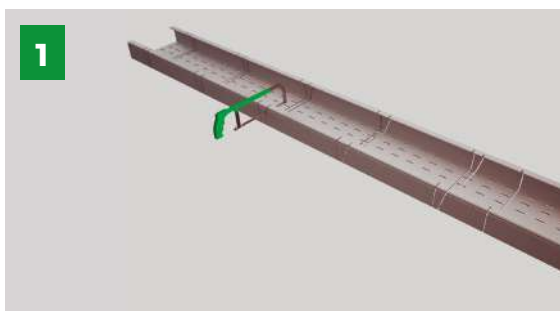

INSTRUCTIONS

1. Cut the tray piece with the cutting saw in 6 pieces making a 45° angle cut.
2. Separate the 6 pieces.
3. Remove any rough edges with the de-burring machine.
4. Make 4 holes on each piece with the electric drill.
5. Put 10 union joints JUBPE-A (223613 for the 60mm or 223614 for the 100mm) in the correct position and fix the union joints on the tray using 40 screws B2-P (210017).

Outside Bends / Small radius

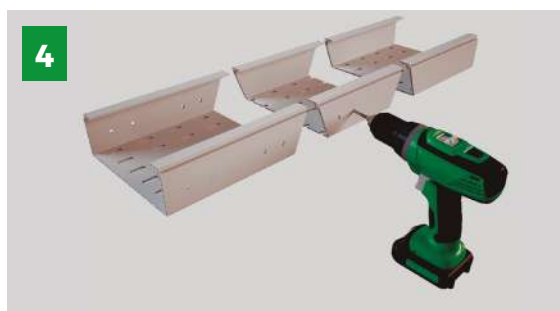
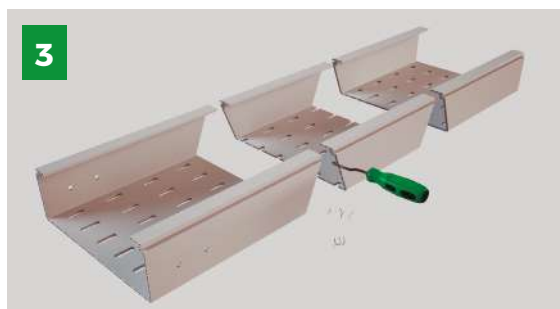
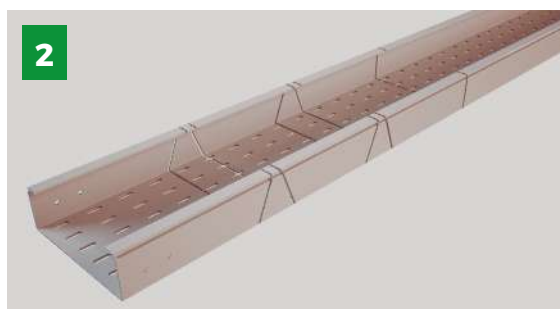

INSTRUCTIONS

1. Cut the tray piece with the cutting saw in 3 pieces making a 45° angle cut.
2. Separate the 3 pieces.
3. Remove any rough edges with the de-burring machine.
4. Make 4 holes on each piece with the electric drill.
5. Put 4 union joints JUBPE-A (223613 for the 60mm or 223614 for the 100mm) in the correct position and fix the union joints on the tray using 16 screws B2-P (210017).

Outside Bends / Right radius

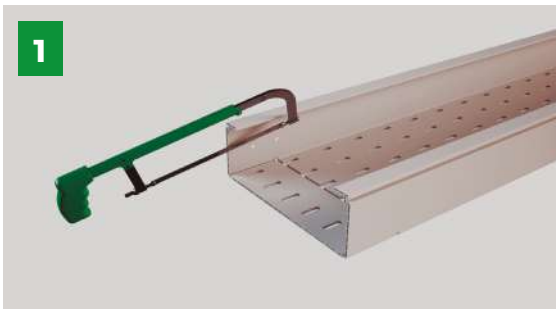

INSTRUCTIONS

1. Cut the tray piece removing the base with the cutting saw.
2. Separate the pieces.
3. Remove any rough edges with the de-burring machine.
4. Make 4 holes on the piece with the electric drill.
5. Put 2 union joints JUBPE-B (223613 for the 60mm or 223614 for the 100mm) in the correct position and fix the union joints on the tray using 8 screws B2-P (210017).

Outside Bends / Large radius

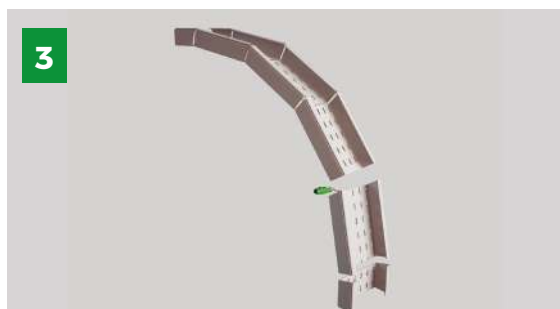
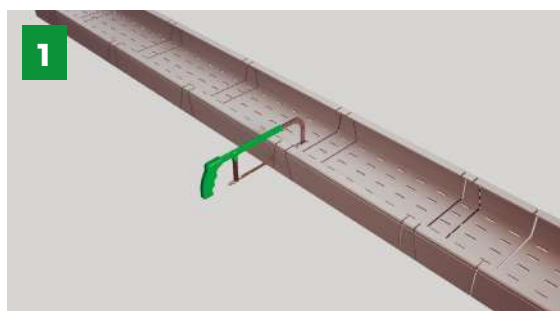

INSTRUCTIONS

1. Cut the tray piece with the cutting saw in 6 pieces making a 45° angle cut.
2. Separate the 6 pieces.
3. Remove any rough edges with the de-burring machine.
4. Make 4 holes on each piece with the electric drill.
5. Put 10 union joints JUBPE-A (223613 for the 60mm or 223614 for the 100mm) in the correct position and fix the union joints on the tray using 40 screws B2-P (210017).

Tee Bends

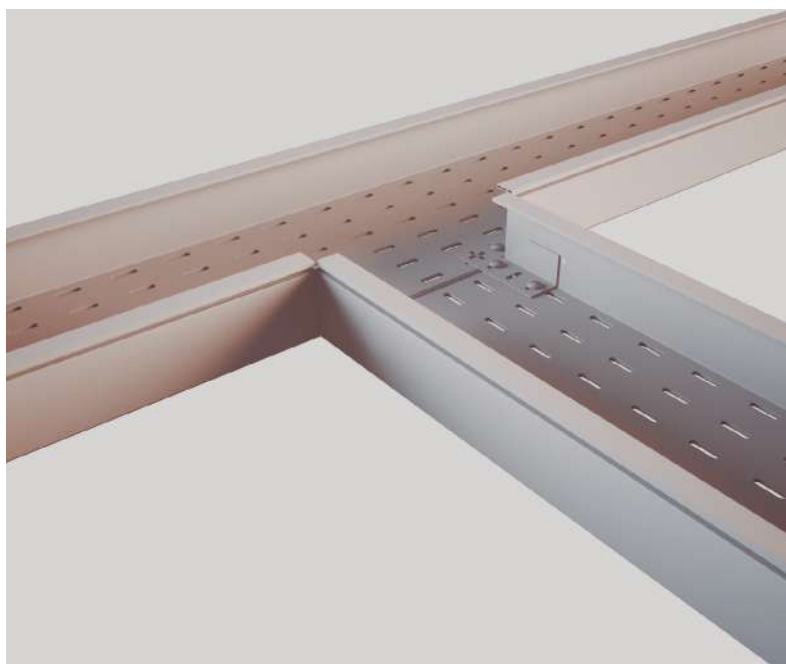
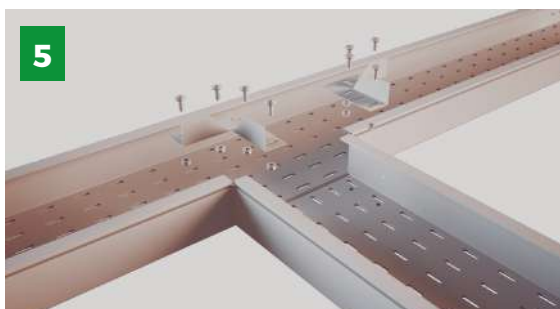
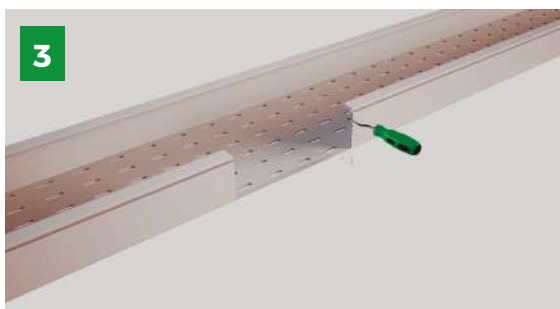
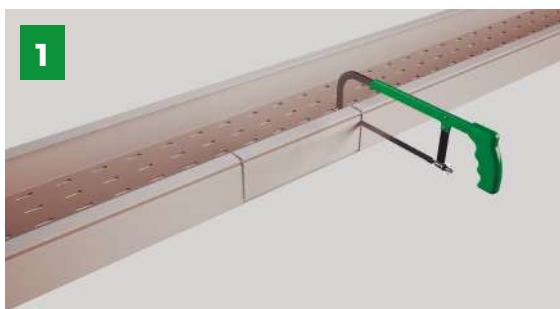

INSTRUCTIONS

1. Cut the tray piece removing the side body with the cutting saw.
2. Separate the 2 pieces.
3. Remove any rough edges with the de-burring machine.
4. Make 4 holes on the piece with the electric drill.
5. Put 2 derivation pieces PDBPE (223021 for high 60mm or 223022 for high 100mm) in the correct position and fix it on the tray using 8 screws B2-P (210017).

Cross Bends

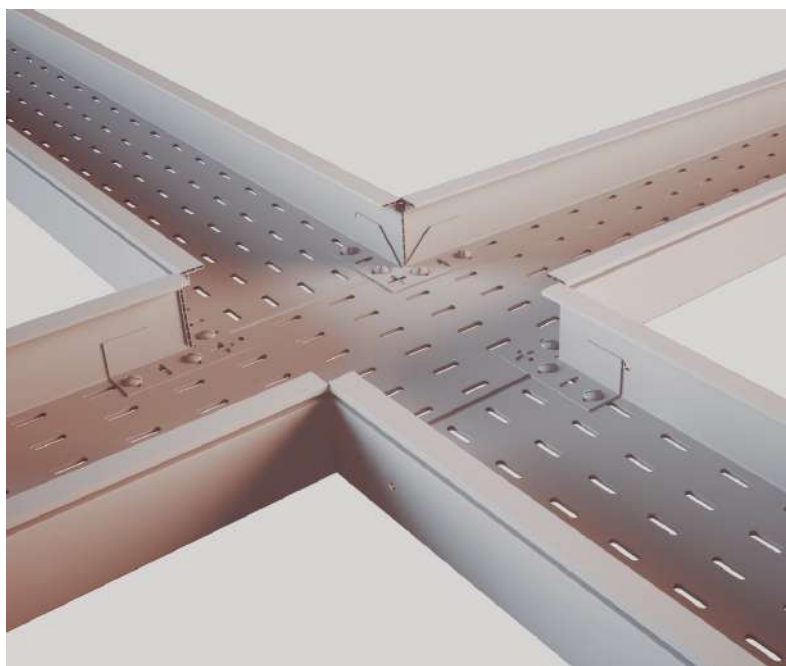
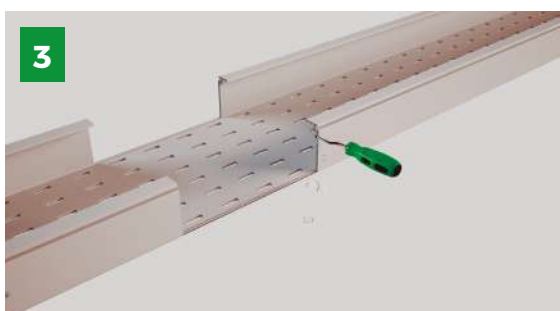
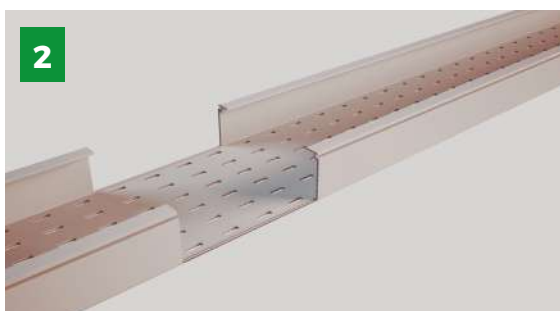

INSTRUCTIONS

1. Cut the tray piece removing the 2 side body with the cutting saw.
2. Separate the 2 piece.
3. Remove any rough edges with the de-burring machine.
4. Make 4 holes on the piece with the electric drill.
5. Put 4 derivation pieces PDBPE (223021 for high 60mm or 223022 for high 100mm) in the correct position and fix it on the tray using 16 screws B2-P (210017).

Elevation Changes

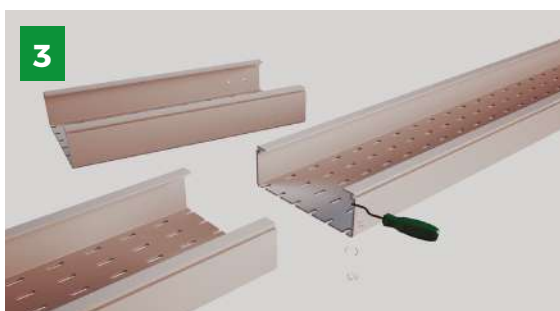
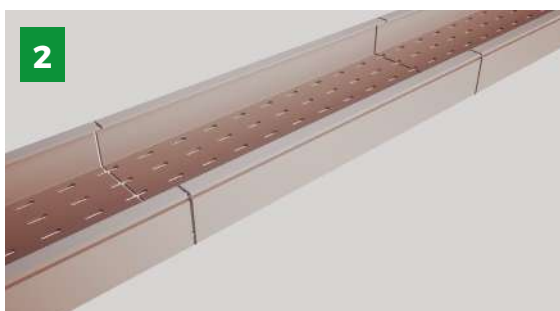

INSTRUCTIONS

1. Cut the tray piece with a cutting saw in 3 pieces making a straight cut.
2. Separate the 3 pieces.
3. Remove any rough edges with the de-burring machine.
4. Make 8 holes on each piece with the electric drill.
5. Put 4 union joints JUBPE-A (223613 for the 60mm or 223614 for the 100mm) in the correct position and fix the union joints on the tray using 16 screws B2-P (210017).

Application on strut / Solid bottom

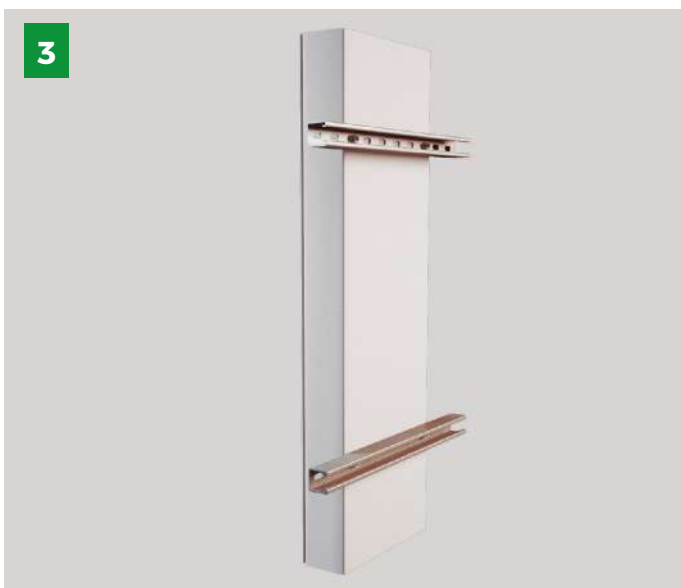
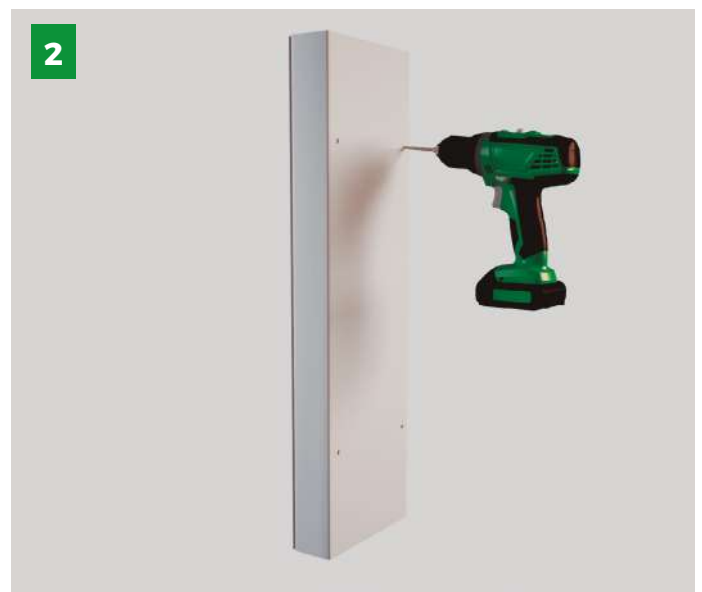
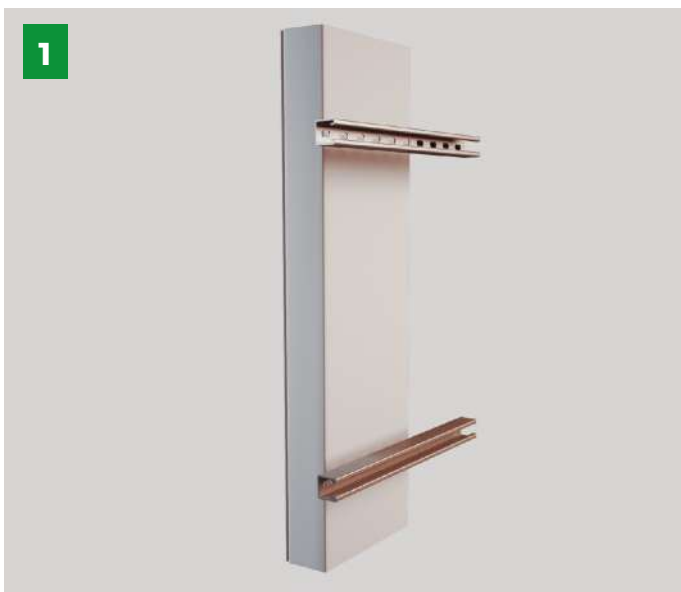

INSTRUCTIONS

1. Put the strut on the base of the tray and mark the holes.
2. Make 4 holes on the tray with the electric drill.
3. Fix the strut on the tray using 4 screws B2-P (210017).

Application on strut / Slotted

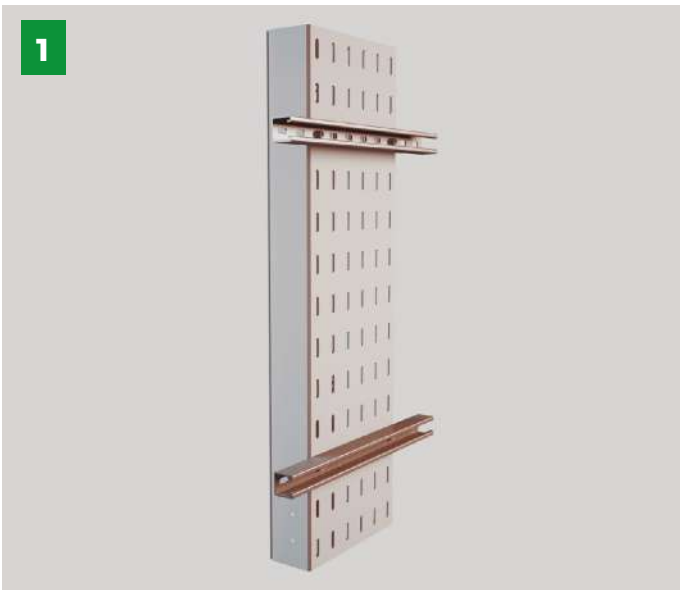
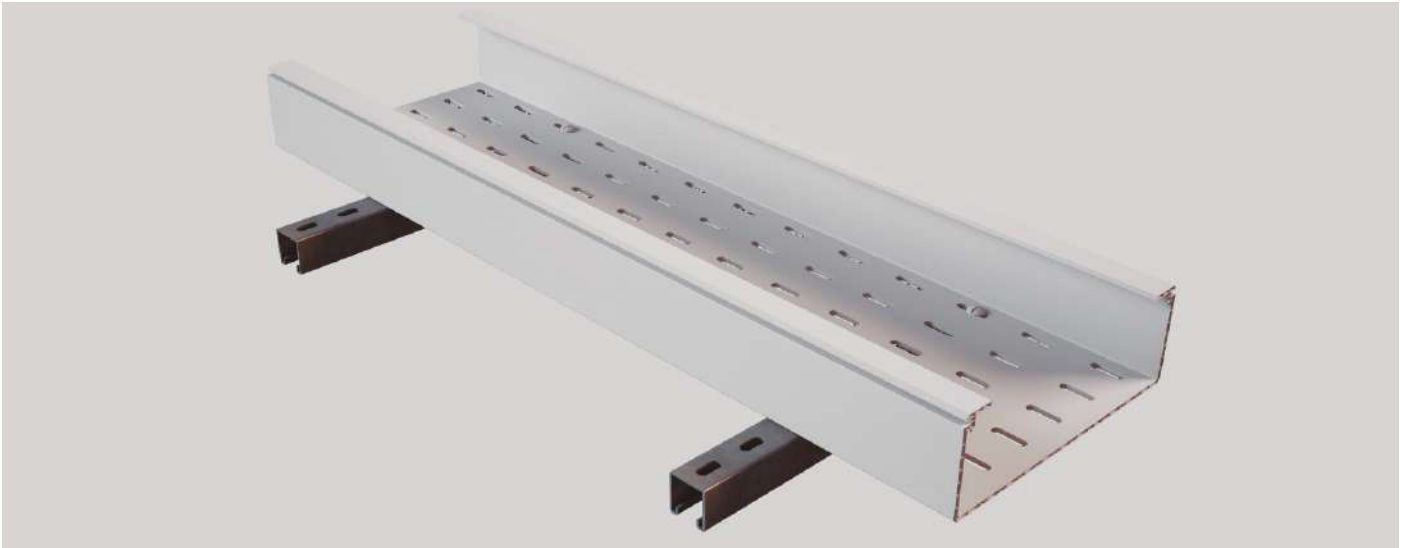

INSTRUCTIONS

1. Put the strut on the base of the tray.
2. Fix the strut on the tray using 4 screws B2-P (210017).

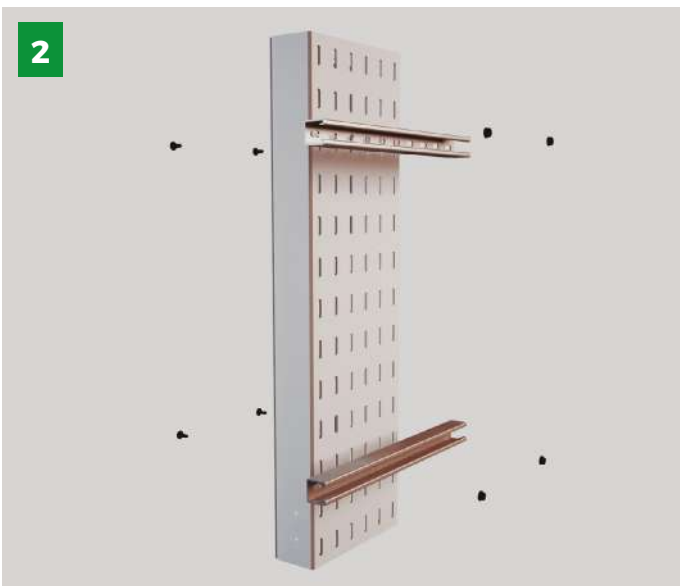

SAFE WORKING LOAD

Installations up to 40 °C

MODEL	Safe Working Load (kg/m)	
	1 m Span	1,5 m Span
BPE-60x100	38	24
BPE-60x150	39	25
BPE-60x200	67	38
BPE-60x300	74	45
BPE-100x200	121	87
BPE-100x300	123	89
BPE-100x400	178	108
BPE-100x600	212	121

Installations up to 60 °C

MODEL	Safe Working Load (kg/m)	
	1 m Span	1,5 m Span
BPE-60x100	28	12
BPE-60x150	30	12
BPE-60x200	45	20
BPE-60x300	50	21
BPE-100x200	73	49
BPE-100x300	81	50
BPE-100x400	114	68
BPE-100x600	133	96

TESTS RESULTS ACCORDING TO UL 568

- Safe working load:

SWL values for 104 °F

NEMA classification	MODEL	Safe Working Load - kg/m (lb/ft)		
		2,4 m (8 ft)	1,8 m (6 ft)	1,5 m (5 ft)
-	BPE-60x100	3,1 (2,1)	5,5 (3,7)	8 (5,4)
-	BPE-60x150	4,2 (2,8)	7,6 (5,1)	10,9 (7,3)
-	BPE-60x200	19,3 (13)	34,3 (23,1)	49,5 (33,2)
5AA	BPE-60x300	21,2 (14,2)	37,8 (25,4)	54,4 (36,5)
5A	BPE-100x200	33,1 (22,3)	59 (39,6)	84,9 (57,1)
8AA	BPE-100x300	52,4 (35,2)	93,2 (62,6)	134,3 (90,2)
8A	BPE-100x400	81,3 (54,6)	144,6 (97,2)	208,3 (140)
8B	BPE-100x600	121,7 (81,8)	216,5 (145,4)	311,7 (209,5)

SWL values for 140 °F

NEMA classification	MODEL	Safe Working Load - kg/m (lb/ft)		
		2,4 m (8 ft)	1,8 m (6 ft)	1,5 m (5 ft)
-	BPE-60x100	2 (1,3)	3,6 (2,4)	5,2 (3,5)
-	BPE-60x150	2,7 (1,8)	4,9 (3,3)	7,1 (4,7)
-	BPE-60x200	12,6 (8,4)	22,4 (15)	32,2 (21,6)
-	BPE-60x300	13,8 (9,3)	24,6 (16,5)	35,4 (23,8)
5AA	BPE-100x200	21,6 (14,5)	38,4 (25,8)	55,3 (37,1)
5A	BPE-100x300	34,1 (22,9)	60,7 (40,8)	87,4 (58,7)
8AA	BPE-100x400	53 (35,6)	94,2 (63,3)	135,7 (91,1)
8A	BPE-100x600	79,3 (53,3)	141 (94,7)	203 (136,4)

Application on brackets

Floor
Support SVG



Wall
Support SHG



Ceiling
Support SVG

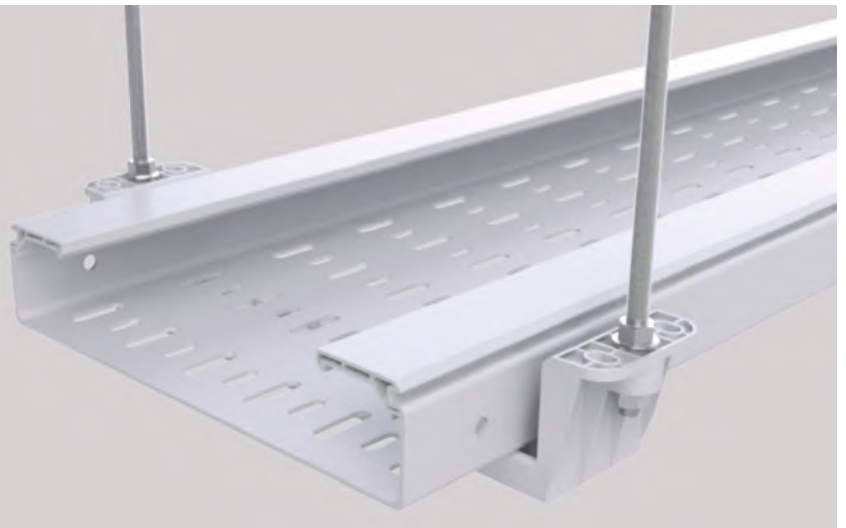

NOTES

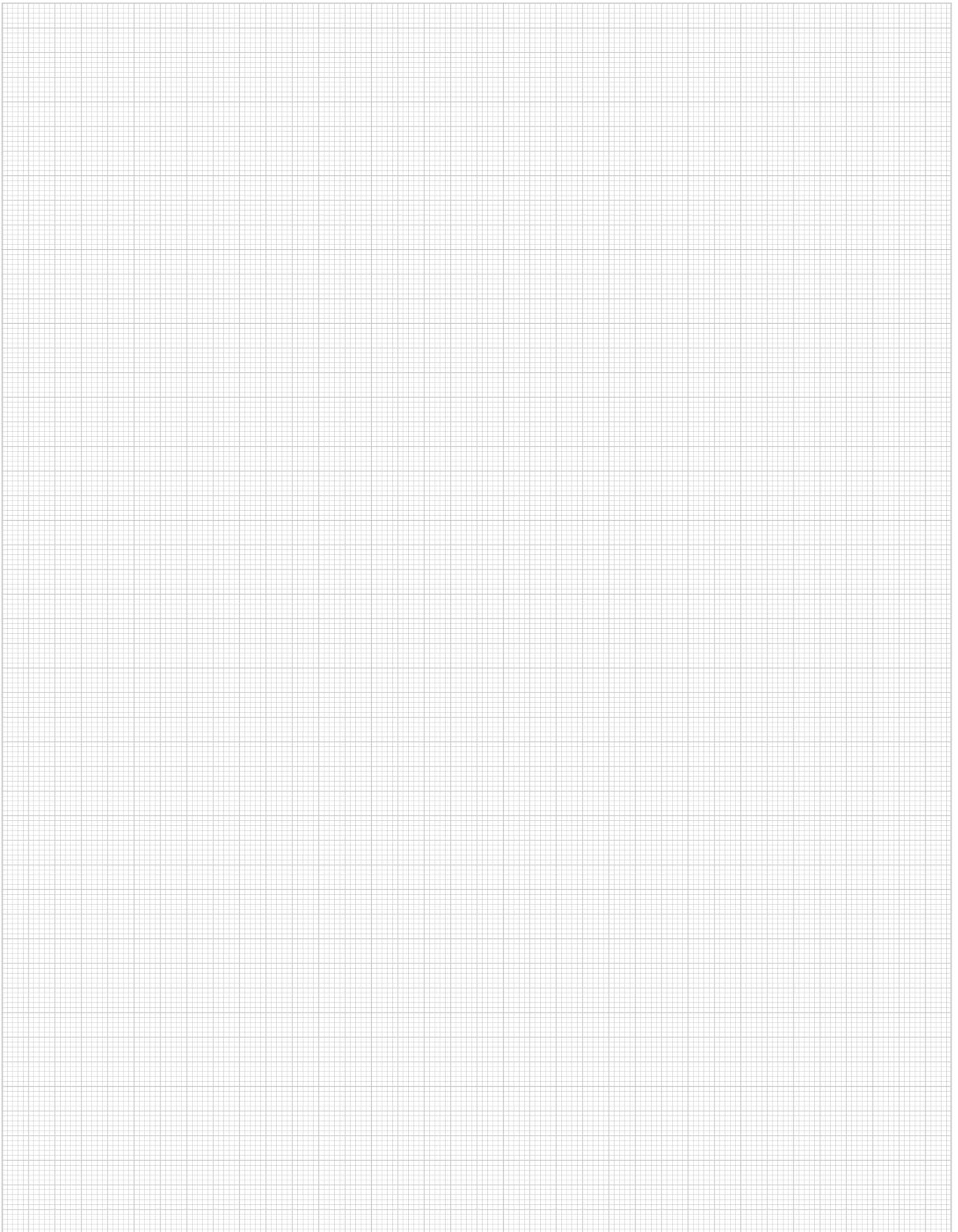

FOLLOW US ON SOCIAL NETWORKS

Do not miss all the latest news from **Basor Electric**: the most up-to-date catalogues, the best projects, assembly and product tips, national and international fairs, corporate information and everything that happens in our offices, factories and subsidiaries.



SCAN THE QR CODES AND DISCOVER OUR PAGES

@Basor Electric SA

@BasorElectric

@BasorElectric



DIETZEL
UNIVOLT

3E Basor
CABLE TRAY SPECIALIST

CABLE MANAGEMENT ALLIANCE



Univolt UK

Unit 4, Quadrant Park
Mundells
Welwyn Garden City
AL7 1FS

T- 01707 379820
W- www.univolt.co.uk
M- sales@univolt.co.uk